

GS-100T30 Free Stop Stay

Top opening · Upward opening · Swing door opening

Opening Direction	Torque
<p>Top-opening Upward-opening Swing Door</p>	$3 \pm 20\% \text{ N} \cdot \text{m/pc}$ $(30.6 \pm 20\% \text{ kgf} \cdot \text{cm/pc})$

Features

- Disk structure that generates torque by the friction of metal plates
- Thin and space-saving, maximising space inside of the cabinet
- Passed 20,000 life cycle test

Notes

- Do not operate continuously (repeatedly in a short time)
- Do not contact with water, oil and lubricant, etc.

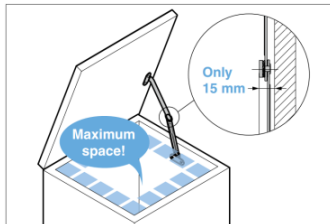

Distance from the mounting surface to the disk surface of stay is only 15mm, maximising space inside of the cabinet.

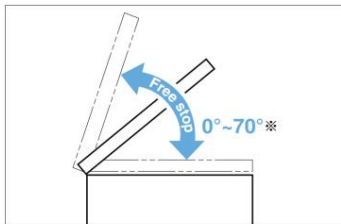

※Opening angle changes depending on installation position.
(70° is for installation as per Fig.1)



Picture shows top-opening installation of GS-100T30R (right-handed)



Picture shows swing door installation of GS-100T30R (right-handed)

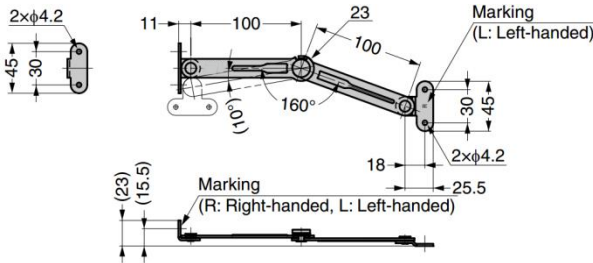

- Relations between door height and door weight for free stop are listed in the table below.
- The following table shows the values for installation as per Fig.1 and Fig.2. For reference only.

Door height (door width for swing door)	Door Weight kg/pc	Door Weight kg/pair
200	Max. 3.9	Max. 7.8
250	Max. 3.1	Max. 6.2
300	Max. 2.6	Max. 5.2
350	Max. 2.2	Max. 4.4
400	Max. 1.9	Max. 3.8
450	Max. 1.7	Max. 3.4
500	Max. 1.5	Max. 3.0

[Right Side Installation
(For Top-opening)]

Fig.1

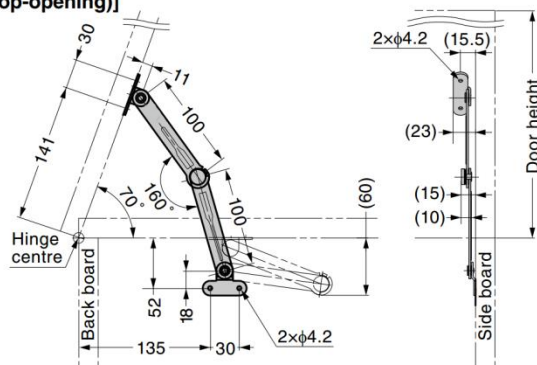

[Right Side Installation
(For Swing Door)]

Fig.2

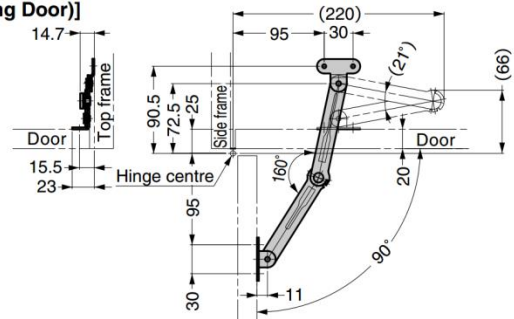

Part No.	Type	Material	Finish	Torque (per piece)	
GS-100T30R	Right-handed	Stainless Steel 430	Barrel Polished	$3 \pm 20\% \text{ N.m}$	$30.6 \pm 20\% \text{ kgf.cm}$
GS-100T30L	Left-handed				